



Miniature Float Switch SMH-6

Miniature liquid level switch for side installation, with plug connection



D-EN-SMH-6-20190426

- Lateral installation with external thread G $\frac{3}{4}$
- Easy alignment with screwed union
- Material: brass
- Connector M12



Miniature Float Switch SMH-6

Miniature liquid level switch for side installation, with plug connection

Typical applications

The mini float switch SMH 6 is used for the reliable monitoring of liquid levels. It is e.g. used for

- Dry running protection
- Overflow protection
- leakage monitoring

Functional Principle

The SMH-6 level monitor is the simple and reliable solution to monitor fluid levels. The installation is made laterally by means of G $\frac{3}{4}$ thread. The proven float principle and a potential-free contact as a signal generator offer high functional safety.

The rising level in the container drives up the swimmer. Through the paddle system, the magnet changes its position to the reed contact and actuates it. The repulsion between the permanent magnets with the same polarity supports the buoyancy. As soon as the level drops again, the swimmer follows and once again activates the reed contact.

The factory-set switching function

- contact closes at rising level
- contact opens at falling level

can be changed by the customer. The reed contact used as a signal generator consists of two ferromagnetic contact tongues, which are located in a protective gas-filled glass bulb. As a result, wear by contact firing is practically impossible. This design allows a lifetime of up to 100,000,000 switching cycles.

Material, wetted parts	
Body, paddle	Brass CW614N
Process connection	Brass CW614N
Female connector	PVDF
Axis	Stainless steel AISI 316 Ti
Magnet	Hard ferrite
Float	PVDF, Brass 2.0401
Gasket	NBR



Miniature Float Switch SMH-6

Miniature liquid level switch for side installation, with plug connection

Technical data	
Switching function	Contact ► Opens at falling level ► Closes as the level rises Conversion possible
Switch-on point, relative to center axis (water, 20 ° C)	-4...0 mm
Switching hysteresis	Approx. 1...4 mm
Nominal pressure	PN 25
Min. density of the medium	
PVDF float	0,78 kg/dm ³
Temperature ranges	
Medium	-10...110 °C
Ambient	-25...80 °C
Electrical data	
Electrical connection	Appliance plug M12
Max. switching current	1 A
Max. switching voltage	230 VAC, 48 VDC
Max. switching power	26 VA, 20 W
Protection EN 60529	IP65
Protection class EN 60730-1	II



Miniature Float Switch SMH-6

Miniature liquid level switch for side installation, with plug connection

Technical drawing

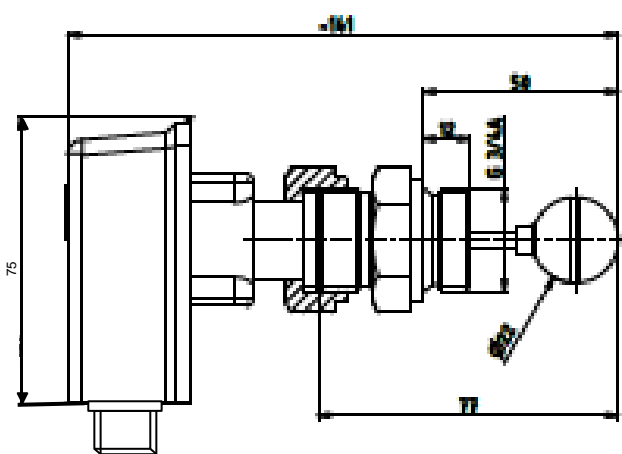

D-EN-SMH-6-20190426

Important instructions!

Technical changes and errors reserved.

Pictures can be similar.

The operating instructions belonging to this device must be observed! Download at www.schmidt-messtechnik.com.