



Level Sensor M02

Level sensor for monitoring of liquids
made of stainless steel, with cable output



- High reliability
- Robust design
- Resistance signal
- Designs up to 6m in length

D-EN-M02-20190605



Level Sensor M02

Level sensor for monitoring of liquids
made of stainless steel, with cable output

Features

- Media compatibility: Oil, water, diesel, refrigerants and other liquids
- Permissible medium temperature range: -30 ... +120 °C [-22 ... +248 °F]
- Output signal: Resistance in a 3-wire potentiometer circuit, current output 4...20 mA
- Measuring principle: Reed-chain technology
- Accuracy, resolution: 24 mm [0.9 in], 12 mm [0.5 in], 10 mm [0.4 in], 6 mm [0.2 in] or 3 mm [0.1 in]

Description

The model M01 level sensor has been developed for measuring the levels of liquids. The stainless steel used is suitable for a multitude of media, such as, for example, oil, water, diesel and refrigerants.

Applications

Due to their high reliability and robust mechanical design, the encoders are ideally suited for industrial use. They work safely and reliably even under harsh operating conditions and can i.a. used in the following industries:

- plant construction
- biochemistry
- chemistry
- turbines
- natural gas
- power plants
- food industry
- mechanical engineering
- offshore
- petro chemistry
- shipbuilding
- pharmacy etc.

Measuring principle

A permanent magnet built into the float triggers, with its magnetic field, the resistance measuring chain built into the guide tube. The entire assembly corresponds to a 3-wire potentiometer circuit. The measured resistance signal is proportional to the level. The model M01 is optionally available with a 4 ... 20 mA analogue output.

Technical data

Output	Level-proportional resistance signal
Operating pressure max.	4.0 MPa
Temperature	-30°C to +120°C Optional up to +150°C
Cable outlet	PVC, silicone
Medium density	≥ 750 kg/m ³
Protection	IP 54, optional IP 68
Accuracy	12 mm
Tube length L	Standard: up to 6000 mm, >6000 mm on request
Process connection	Standard: 3/8", G1/2", Other versions on request



Level Sensor M02

Level sensor for monitoring of liquids
made of stainless steel, with cable output

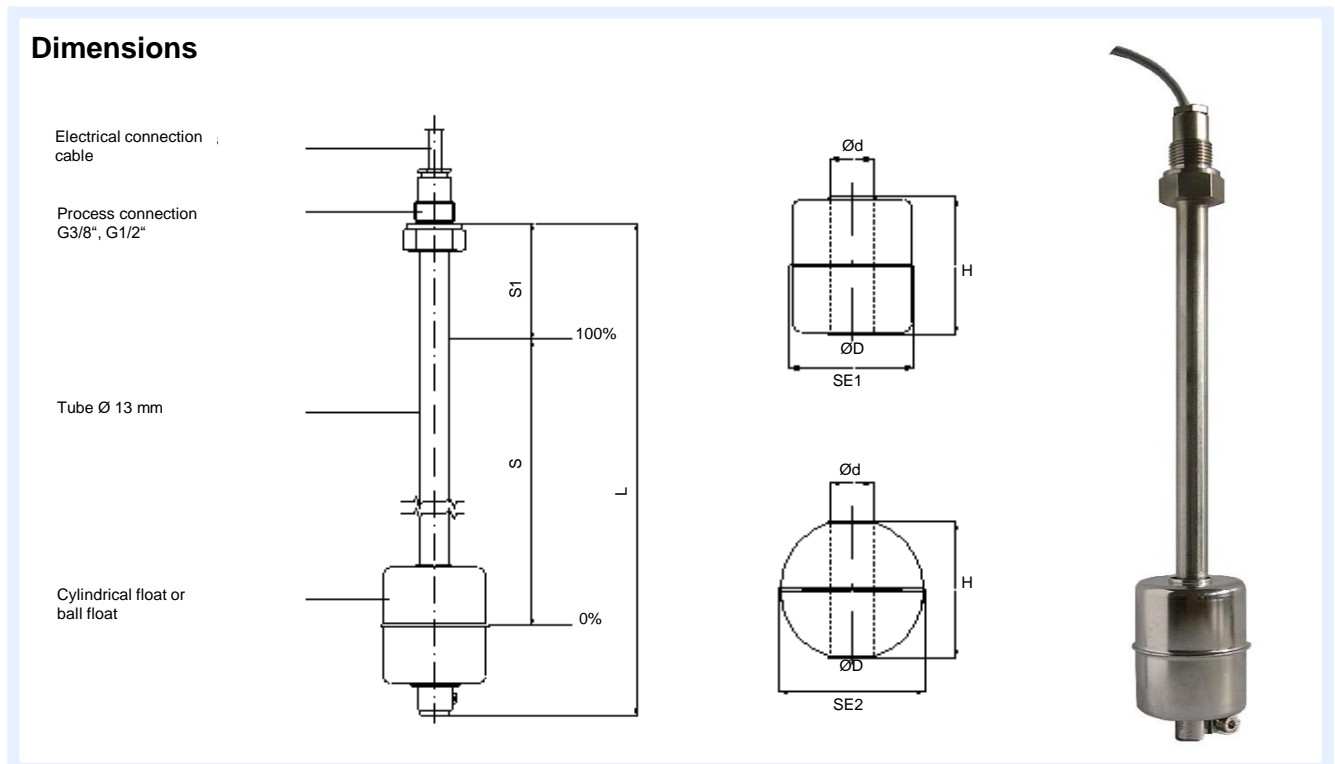

Float type	Dimensions (mm)			Operating pressure max. (MPa)	Operating temperature max. (°C)	Medium density (kg/m ³)	Material
	Ø D	Ø d	H				
SE1 Cylindrical float	44	15	52	1,6	120	≥ 750	1.4571
SE2 Ball float	52	15	52	4,0	120	≥ 750	1.4571

Electrical connection



Important instructions!

Technical changes and errors reserved.

Pictures can be similar.

The operating instructions belonging to this device must be observed! Download at www.schmidt-messtechnik.com.



Level Sensor M02

Level sensor for monitoring of liquids
made of stainless steel, with cable output

Ordering information

M 02

Process connection (Mounting position: vertical, $\pm 30^\circ$)

A Mounting screw thread G $\frac{3}{8}$ ", 1.4571

B Mounting screw thread G $\frac{1}{2}$ ", 1.4571

X other versions on request

Tube length L (see „Dimensions“)

Tube material 1.4571

Tube length from sealing surface process connection

Tube length $L \leq 6000$ mm; $L > 6000$ mm on request

Indication in mm

Float type

A SE1 (Cylindrical float $\varnothing 44$, material 1.4571)

B SE2 (Ball float $\varnothing 52$, material 1.4571)

X other versions on request

Temperature range

C -30°C to $+80^\circ\text{C}$

D -30°C to $+120^\circ\text{C}$

Length of the cable

Indication in m

M 02					
------	--	--	--	--	--

S1 =	
------	--

Distance sealing face to 100 % mark
($X \geq$ dead band T in mm [in] (from sealing edge))