



Flow Monitor / Flow Indicator RVO/U-4

Float measuring principle for liquids



D-EN-RVOU4-20200526

- Thread G 1/4"
- High functional reliability
- High switch accuracy



Flow Monitor / Flow Indicator RVO/U-4

Float measuring principle for liquids

Areas of Application

- Mechanical engineering
- Medical technology
- Pharmaceutical industry
- Chemical industry
- Research and development
- Cooling systems and cooling circuits

Charakteristika

- High functional reliability
- High switch accuracy
- Scales are burned-in on the sight glass
- Threaded connection, special threads on request

Operating data

Operating pressure max.	16 bar
Pressure drop	0,02 – 0,2 bar
Temperature max.	100 °C (optional 160 °C)
Accuracy	±10 % of full scale

Measuring ranges

Type	Operating Range for H ₂ O, 20 °C (1)		
	[lmin]	[gph]	[gpm]
RVO/U-4/01	0,005 – 0,06	0,08 – 0,95	
RVO/U-4/02	0,025 – 0,13	0,4 – 2,0	
RVO/U-4/03	0,06 – 0,3	1,0 – 4,8	
RVO/U-4/06	0,1 – 0,6	1,6 – 9,5	
RVO/U-4/1	0,2 – 1,2	3,0 – 19,0	
RVO/U-4/2	0,4 – 2		0,1 – 0,5
RVO/U-4/3	0,5 – 3		0,13 – 0,8
RVO/U-4/5	1 - 5		0,25 – 1,3

(1) The specified data are switch-off points.
Other switch ranges on request.



Flow Monitor / Flow Indicator RVO/U-4

Float measuring principle for liquids

Technical drawing

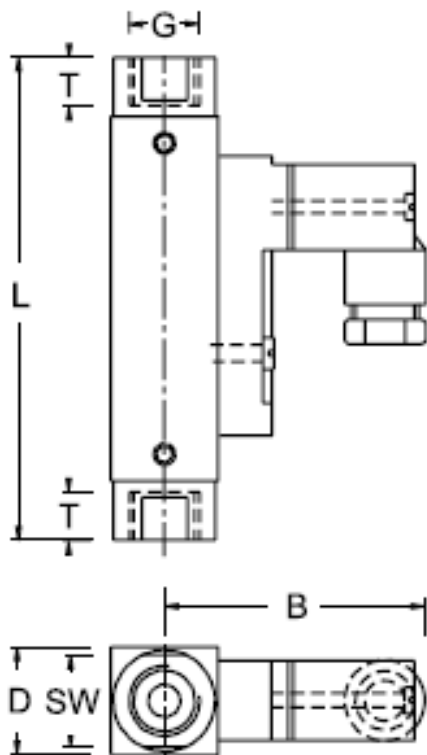

Summary of Types								
Type	Overall dimensions [mm]							Weight approx. [g]
	SW	D	B	G	DN	T	L	
RVO/U-4/01	17	20	49	1/4"	8	10	90	140
RVO/U-4/02								
RVO/U-4/03								
RVO/U-4/06								
RVO/U-4/1								
RVO/U-4/2								
RVO/U-4/3								
RVO/U-4/5								

D-EN-RVOU4-20200526



Flow Monitor / Flow Indicator RVO/U-4

Float measuring principle for liquids

Connection diagram

Connector in compliance with EN 175301-803 and cable

M12x1

Change over (COC)



Change over (COC)



Normally open (NOC)



Normally open (NOC)



Pin-assignment

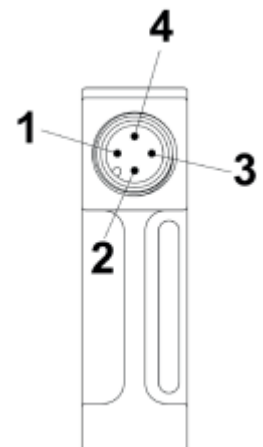



Flow Monitor / Flow Indicator RVO/U-4

Float measuring principle for liquids

Electrical data		
Change over (2)	200 V • 1 A • 20 VA	
Normally open	200 V • 1 A • 20 VA	
Change over M 12x1 (-20 °C – 85 °C)	125 V • 1 A • 20 VA (2)	
Normally open M 12x1 (-20 °C – 85 °C)	125 V • 1 A • 20 VA	
Change over SPS (3)	250 V • 1 A • 60 VA	
Ingress protection: IP 65: plug connection DIN 43650 Form C or plug connection M 12x1 IP 67: 1 m sealed cable		
Output signal	The contact opens / changes when the flow decreases below the set point.	
Power supply	Not required (potential free reed contacts)	
Plug types	Other plug types or cable lengths on request	
(2) Plug connection required.		
Material	Brass version	Stainless steel version
Sight glass	Duran® 50	Duran® 50
Spring	1.4571	1.4571
Gaskets	NBR (optional FKM, EPDM) (3)	FKM (optional NBR, EPDM) (3)
Magnets	Hard ferrite	Hard ferrite
All other wetted parts:	Brass nickel-plated	1.4571
Not wetted parts: Housing	Aluminum anodized	Aluminum anodized
(3) Other gasket materials on request		

Important instructions!

Technical changes and errors reserved.

Pictures can be similar.

The operating instructions belonging to this device must be observed! Download at www.schmidt-messtechnik.com.

D-EN-RVOU4-20200526