



## Flow Indicator with Rotor WR

Flow indicator for liquids



D-EN-WR-20190416

- All positions
- Insensitive to dirt
- Cleaning during operation



## Flow Indicator with Rotor WR

Flow indicator for liquids

### Characteristics

Mechanical flow indicator, for fluid media, with rotor for quantitative flow display. The rotor turns in proportion to the flow. Robust construction in brass or stainless steel..

### Features

- Internal wiper provides ability to clean the glass without removing the device.
- Sliding bearing made from PEEK for liquids, or grease-free ball bearing for air and gases
- Rotor visible from 360 °

Operating data	WR
Operating pressure max.	PN 16 bar
Pressure loss	0,25 bar
Temperature max.	100° C

### Installation instructions

The flowmeter can be installed anywhere in the system. The direction of flow must be observed.

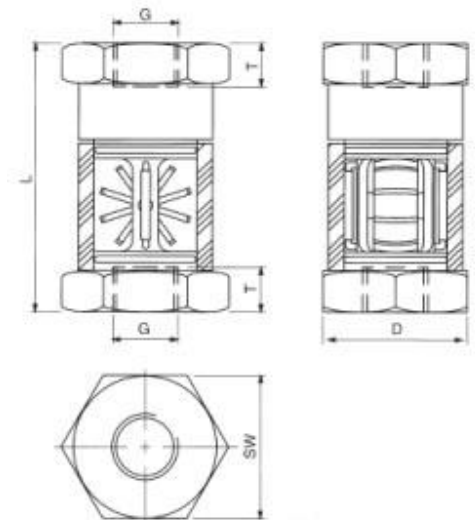

Dimensions								
Type	Flow rate min. l/min H <sub>2</sub> O	Flow rate max. l/min H <sub>2</sub> O	Dimensions mm					
			G	SW	D	T	L	ca. g
WR-8	0,4	4	1/4"	36	30	12	71	300
WR-10	0,6	8	3/8"	36	30	14	75	300
WR-15	1,0	12	1/2"	46	40	14	86	600
WR-20	1,0	25	3/4"	46	40	16	95	600
WR-25	1,6	40	1"	46	40	18	105	600
WR-32	7,5	80	1 1/4"	70	65	20	120	1500
WR-40	8,0	100	1 1/2"	70	65	22	130	1600

D-EN-WR-20190416



## Flow Indicator with Rotor WR

Flow indicator for liquids

Material	Brass	Stainless steel
Housing	Nickel-plated brass	1.4305
Rotor	POM	POM
Sight glass	DURAN	DURAN
Wiper	Polyolitin	Viton
Gaskets	Perbunan	Viton

### Important instructions!

Technical changes and errors reserved.

Pictures can be similar.

The operating instructions belonging to this device must be observed! Download at [www.schmidt-messtechnik.com](http://www.schmidt-messtechnik.com).