

Strömungswächter Flow Controller

Sensoren
Sensors

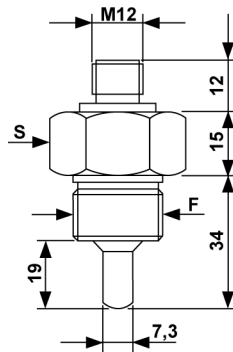

STA 421 S...

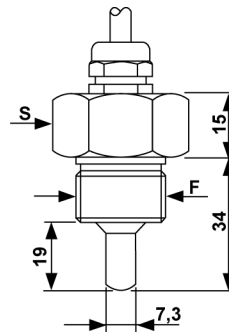

STA 421 K...

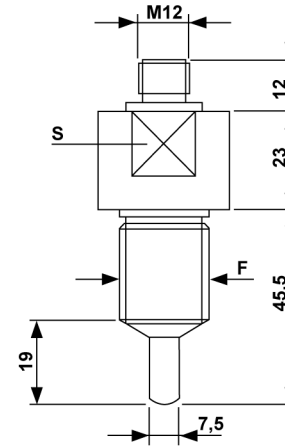

STD 421 S.../ STD 431 S...

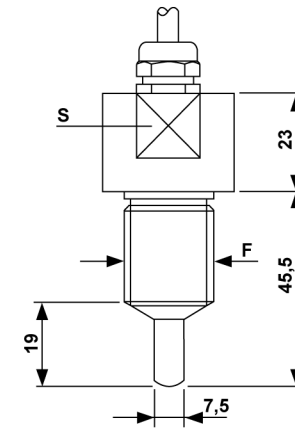

STD 421 K.../ STD 431 K...

Typ/Type	ID	F	S	(I)	(II)	(III)	(IV)	(V)	(VI)
STA 421 S-B3	P10622	G 1/2	27	3.7035/B3	IP 67	100	-20...80	1...150	3...300
STA 421 K-B3	P10623	G 1/2	27	3.7035/B3	IP 68	100	-20...80	1...150	3...300
STA 421 K-HB2	P10625	G 1/2	27	2.4617	IP 68	100	-20...80	1...150	3...300
STA 421 K-HC22	P11159	G 1/2	27	2.4602	IP 68	100	-20...80	1...150	3...300
STD 421 K-A4	P10611	G 1/2	27	1.4571	IP 68	400	-20...80	1...150	3...300
STD 421 S-A4	P10613	G 1/2	32	1.4571	IP 67	400	-20...80	1...150	3...300
STD 431 K-A4	P10615	G 3/4	27	1.4571	IP 68	400	-20...80	1...150	3...300
STD 431 S-A4	P10617	G 3/4	32	1.4571	IP 67	400	-20...80	1...150	3...300

Technische Daten / Technical Data

(I) Werkstoff / Material

1.4571 ≙ AISI 316Ti

(II) Schutzart / Protection

(III) Druckfestigkeit (statisch) / Compressive strength (static) [bar]

(IV) Umgebungstemperatur / Ambient temperature [°C]

Erfassungsbereich / Detection range

(V) Wasser / Water [cm/s]

(VI) Öl / Oil [cm/s]

Technische Daten / Technical Data

Erfassungsbereich/ <i>Detection range:</i>	
Wasser/ <i>Water</i>	1...150 cm/s
Öl/ <i>Oil</i>	3...300 cm/s
Temperaturgradient/ <i>Temperature gradient</i>	250°C/min
Temperaturbereich/ <i>Temperature range</i>	-20...80°C
Bereitschaftszeit/ <i>Stand-by time</i>	2...15 s
Einschaltzeit/ <i>Switch-on time</i>	1...13 s
Ausschaltzeit/ <i>Switch-off time</i>	1...15 s

Anschluss / Connection

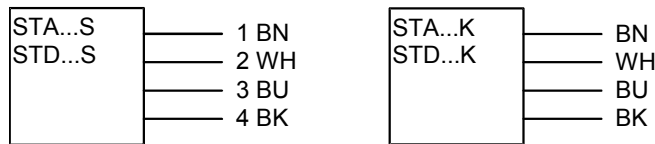

Farbcode / Code

BK:Schwarz/*black* BN:Braun/*brown* BU:Blau/*blue* GY:Grau/*grey* WH:Weiß/*white*

Steckerbelegung / Plug

M12 x 1

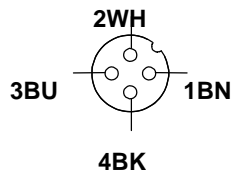

Ersatzschaltbild / Circuit diagram

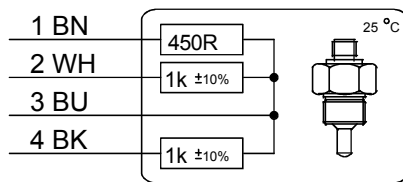

Kabelverlängerungen / Cable length

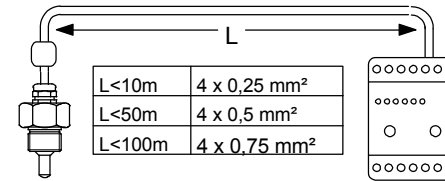

Dichtung / Gasket

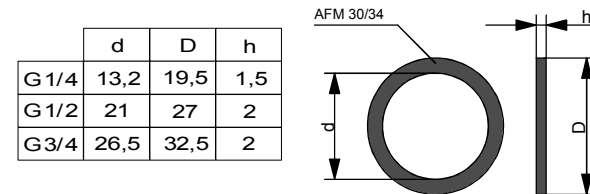

Einbau / Installation

Die Einbaulage des Sensors sollte gewährleisten, daß die Meßspitzen des Sensors vollständig von dem zu überwachenden Medium umgeben sind. Ablagerungen am Sensor können die Funktion beeinflussen. *The sensor tip must be fully immersed into the medium after installation. Deposits impair the function of the flow controller.*

